



Shaft Screening Buckets

	PSB2 700	PSB2 1500	PSB3 1500	PSB4 1500	PSB3 1700	PSB4 1700	PSB3 2300	PSB4 2300
Excavator	3,5-7	8-10	10-14	14-21	22-25	25-32	28-35	35-45
Wheel Loader	2-3	4-7	7-10	9-15	12-16	14-20	18-25	21-30
Min-max (l/min)	30-60	40-70	40-70	90-13	110-180	110-180	130-200	130-200
Bar	200	200	200	200	200	200	200	200
ISO/SAE (m3)	0,15/0,19	0,6/0,7	0,7/0,8	1,1/1,2	2,0/2,2	2,7/3,0	3,0/3,4	3,9/4,5
Screen Area (m2)	0,3	0,6	1,0	1,3	14	1,6	2,0	2,4
Weight (kg)	280	690	980	1350	2100	2750	2750	3200

Blade models:



**M20903 110-STANDARD
& B20485 140-STANDARD**

Most popular model, this type of blade is used in screening all types of materials, top soil, peat, fertilizers, chopped wood, and demolition waste.



**M23709 110 2SC &
B23247 140 2SC**

With this type of blade design it is possible to screen and crush light materials such as biomaterials, frozen or lumped materials (fertilizers, mineral concentrates, peat, gypsum, clay).



**M24752 110 4SC
& B23909 140**

Same usage as the Blade models M23709 110 2SC and B23247 140 2SC but all four corners are cutting when rotation one direction, so a more aggressive cut.

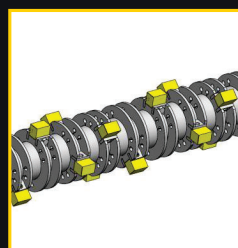

**CBB 24251 140
BoltBlock**

This model has an aggressive cutting/mixing effect, even soft tiles (clay tiles) can be crushed. The yellow blocks are bolted and can be replaced easily when wearing out.

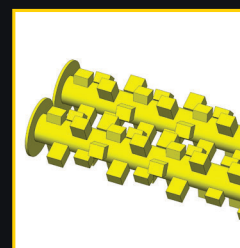

**STA 23984 110
BigBlock**

Used to mix, aerate and stabilize materials. Aerating compost, mixing different materials (clay, bentonite, sand, peat, limestone). For ex. Stabilizing clay with limestone and bentonite (stabilising contaminated soil, stabilising wet ground), also crushing moist lumps of minerals, lime.

Product features

- A** Chain driven
- B** Large screening area
- C** Shaft options available
- D** Bolt on wear edges (optional)
- E** Extra capacity bolt-on guard (optional)